

MODELS	REFERENCE	CONSTRUCTION	VENTILATION	CONNECTION PLATES (6) x 2	CONNECTION PLATES (9) x 2	INTERIOR LIGHT	DOUBLE GLASS	SILENT BLOCKS	AC CONNECTION	OSCILATING BASE
A-SR 70	02050ASR70	Metal	Free	X	opt	X	X	X	X	X
A-SR 75	02050ASR75		Free	X	opt	X	X	X	X	X
A-SR 80	02050ASR80		Forced		X	X	X	X	X	X
A-SR 85	02050ASR85		Forced		X	X	X	X	X	X
A-SR 90	02050ASR90		Forced		X	X	X	X	X	X
A-SR 95	02050ASR95		Forced			X	X	X	X	X
B-SR 70	02050BSR70	Plated Wood	Free	X	opt	X	X	X	X	X
B-SR 75	02050BSR75		Free	X	opt	X	X	X	X	X
B-SR 80	02050BSR80		Forced		X	X	X	X	X	X
B-SR 85	02050BSR85		Forced		X	X	X	X	X	X
B-SR 90	02050BSR90		Forced		X	X	X	X	X	X
B-SR 95	02050BSR95		Forced			X	X	X	X	X
C-SR 70	02050CSR70	Wood	Free	X	opt	X	X	X	X	X
C-SR 75	02050CSR75		Free	X	opt	X	X	X	X	X
C-SR 80	02050CSR80		Forced		X	X	X	X	X	X
C-SR 85	02050CSR85		Forced		X	X	X	X	X	X
C-SR 90	02050CSR90		Forced		X	X	X	X	X	X
C-SR 95	02050CSR95		Forced			X	X	X	X	X

> Options / Opciones

> Sound Isolation level / Aislamiento acústico @ 8 kHz

- Access ramp for wheelchairs
- Forced ventilation
- Audiometer connection cords (more than 3)
- Replacement lamp
- Exterior table
- Interior light dimmer
- Acoustic isolation certificate
- Connection panel (6) + power outlet + general switch
- Connection panel (9) + USB + power outlet + general switch



> Measures (w x l x h) / Medidas

> Customized measures and configurations available / Medidas y configuraciones personalizadas

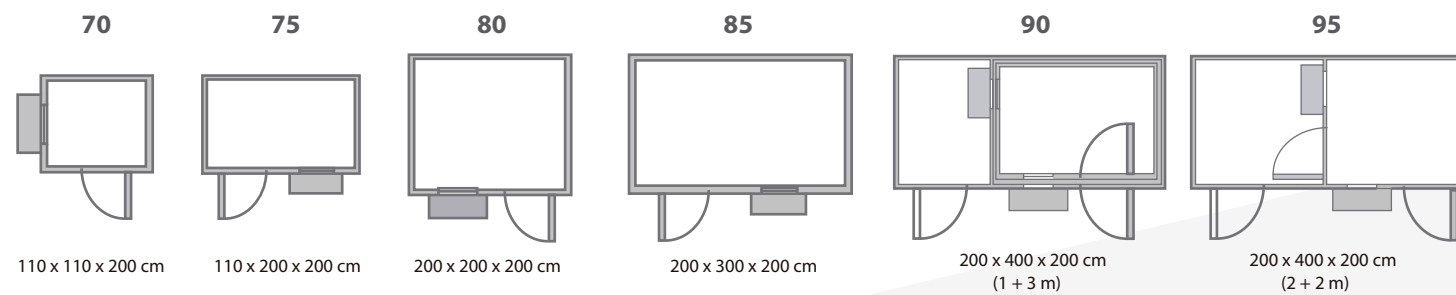

> Connection plate (6) / Placa de conexión (6)

> Panel construction / Construcción de paneles

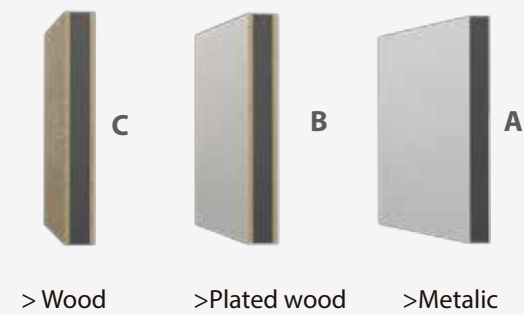
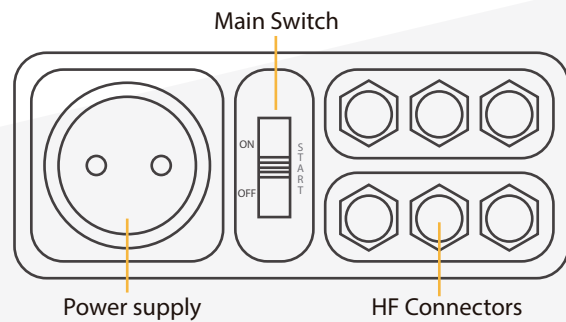

SILENT ROOMS



CUSTOMIZED SILENT BOOTHS

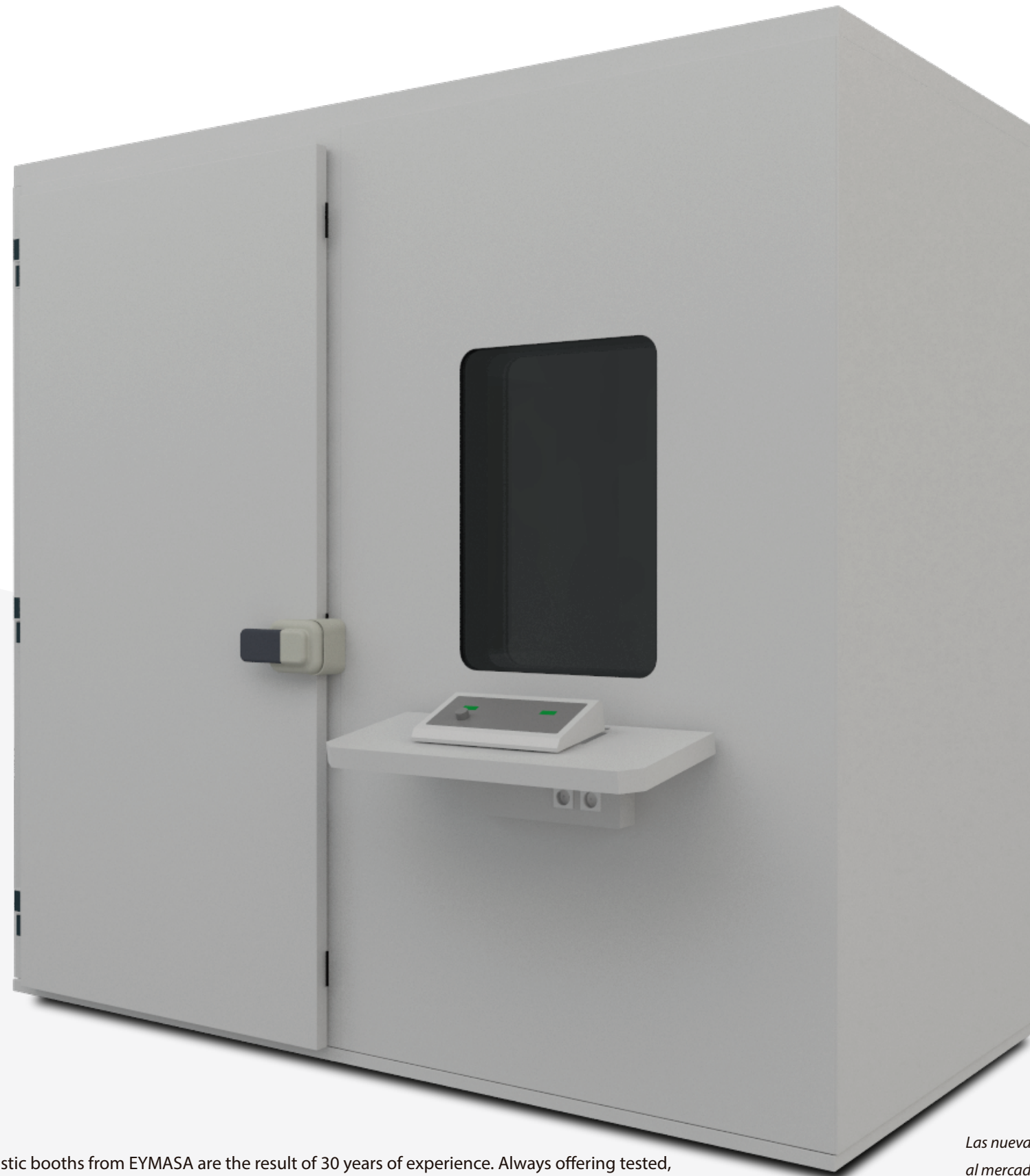

Double glass / Cristal doble



Access ramp / Rampa de acceso

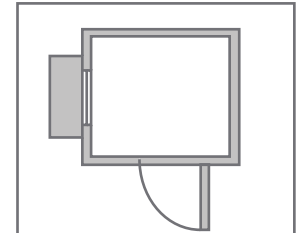
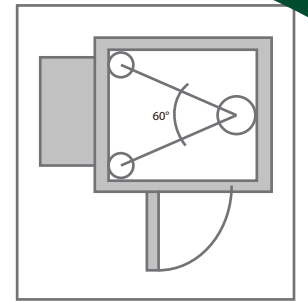

Single wall

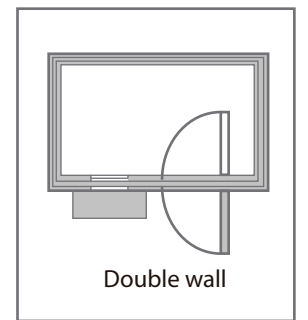
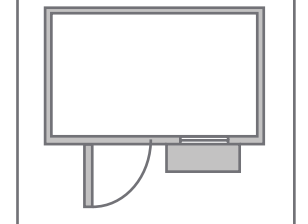

Double wall

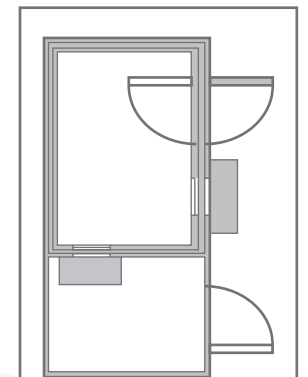

Double wall, double room

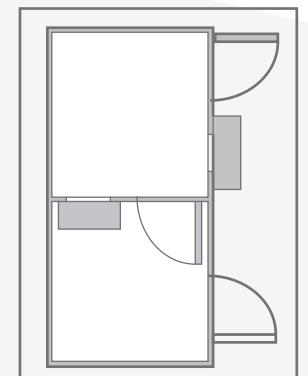

Single wall, double room

The new acoustic booths from EYMASA are the result of 30 years of experience. Always offering tested, verified and highly valued products in more than 60 countries. This makes them the booths with the highest reputation in the market. The new EYMASA booths add to their traditional panel system a new metal profile assembly. They are easier to assemble, more hermetic, versatile and non-deformable. This allows the possibility to make different configurations. Optionally, any kind of configuration and measurement is possible by the request of our clients. Constructed over tilting bases, reducing vibrations. Always according to the most rigorous standards of quality according to the norms 93/42/CEE and UNE EN-ISO 13485.

Las nuevas cabinas acústicas de EYMASA son el resultado de los 30 años de experiencia de la marca ofreciendo siempre al mercado unos productos ensayados, verificados y altamente valorados por los profesionales de la acústica médica de más de 60 países, haciendo que sean de las cabinas con mayor reputación de las existentes. Las nuevas cabinas EYMASA añaden a su tradicional sistema de paneles de la marca, una estructura propia de perfiles de acero, para que sean más fácilmente ensambladas, más herméticas, más versátiles e indeformables, permitiendo incluso la posibilidad de realizar diferentes configuraciones en un futuro. Opcionalmente se podrá construir cualquier versión conforme a los requerimientos del cliente. Construidas sobre elementos basculantes y aislantes de las vibraciones. Siempre conforme a los más rigurosos estándares de calidad según la normativa 93/42/CEE y UNE EN-ISO 13485.